



Sherman Creek Master Plan

Experience Relevance

- Phase I Site Investigation
- Phase II site Investigation
- Environmental Mitigation Studies & Remedial Action Plan
- River park along Manhattan Upper East Side
- Work on Structures along shorelines



Plan Scope

Alcance del Plan

Sherman Creek is a small embayment of the Harlem River on the east side of northern Manhattan, in the vicinity of 200th Street. The primary study area is between Dyckman Street, Broadway, West 207th Street and the Harlem River, and includes Sherman Creek inlet, for which the surrounding area was named. The area which was the focus of the Master Plan is an underutilized waterfront site that has significant potential to be converted into a waterfront development and esplanade. The purpose of the environmental assessment reports, planning, and analysis effort performed by GRB was to assess current environmental

data and collect new information necessary to support development of the Master Plan, maximize the current and future development of the site, and obtaining baseline information for eventual site remediation, i.e., the phase that will ready Sherman Creek for its transformation into a viable and vibrant public area. For this transformation to proceed smoothly, and allow the creative vision to unfold, the assessment needs assessed by GRB had to be complete in order to minimize unknowns. GRB was the environmental consultant on the Weisz Yoes Architecture team.

Previous site assessment/site investigation reports focused on different segments of the site area and did not address the site as a whole. GRB reviewed existing reports and identified environmental issues that included the following:

- Underground storage tanks associated with gasoline stations
- The presence of monitoring wells
- Former Consolidated Edison Coal Base Electric Plant



Existing Structure in Sherman Creek

The Phase I Environmental Site Assessment performed by GRB was in general accordance with the guidelines of the American Society for Testing and Materials (ASTM) Standard Practices E 1527-05. Based on the findings of the Phase I report GRB prepared a Work Plan for a Phase II report which addresses groundwater quality, soil quality, surface water quality, and sediment quality. Based on the findings of the Phase II Site Investigation, GRB prepared a Contaminated Soil Specification and a Construction Health and Safety Plan. The specifics of the specification and the Contaminated Soil Specification focused on the following elements:



Sherman Creek Master Plan

- handling of contaminated soil
- storage of contaminated soil
- transport of contaminated soil
- disposal of contaminated soil
- waste manifesting

GRB prepared a remedial action plan and developed remedial costs estimates for project funding purposes. Based on GRB’s findings and recommendations, the Master Plan was able to maximize the use of space without being encumbered by any environmental constraints. Below is a schematic of the northern area of the Sherman Creek Master Plan and the overall Conceptual Site Plan.

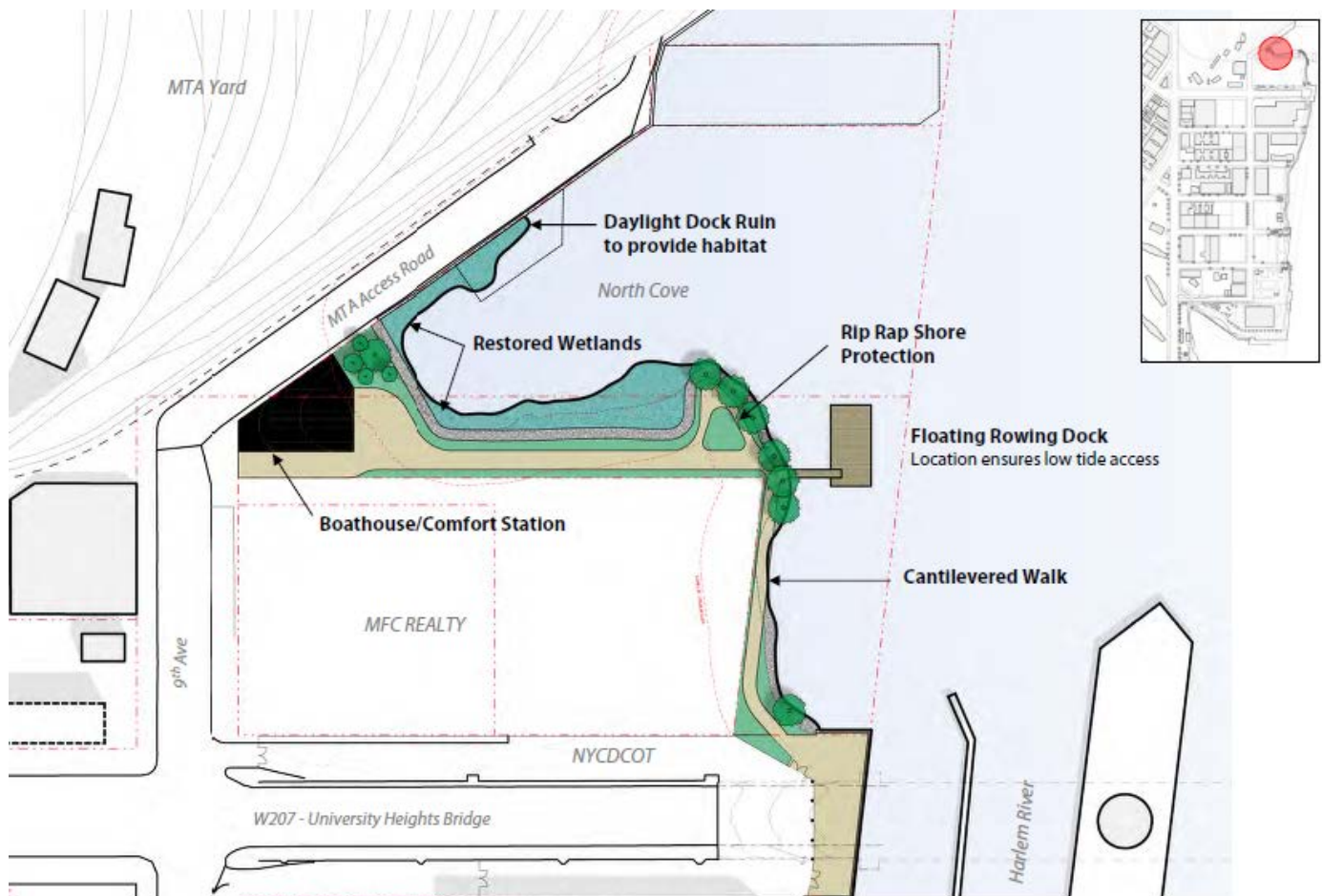

2B North of W207 Boathouse/Rowing Dock/Restored Wetlands
Varadero / Muelle para Canotaje / Humedales



GRB Environmental Services, Inc.
Project Description

Sherman Creek Master Plan



Conceptual Site Plan

Plano Conceptual del Sitio